

Deadbolt Installation Instructions

1 Mark Door

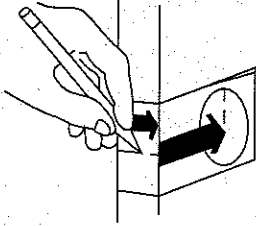

A. Fold and apply installation template to edge of door and mark centre of door edge as indicated on the template at the desired height.

2 Drill holes

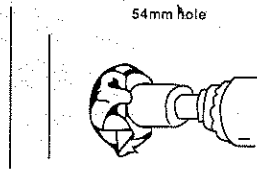

A. Drill through door face as marked for the lock body. It is recommended that a pilot hole be drilled through the door first then drill the 54mm (2 1/8") hole from both sides of the door.

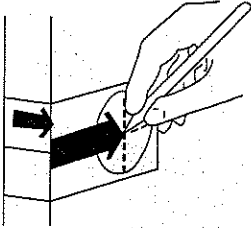

B. Mark centre hole on the door face through guide on template for 60mm (2 3/8") backset or 70mm (2 3/4") backset.

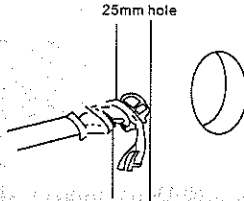

B. Drill 25mm (1") hole in edge of door through to the 54mm (2 1/8") hole.

3 Install Tubular Bolt

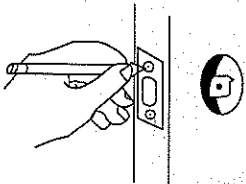

A. Insert Tubular bolt in hole, insure the face plate is parallel to door edge. Mark outline of the face plate and remove bolt.

4. Install Lock Body

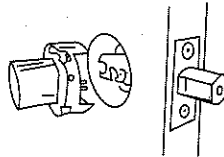

A. With the bolt extended, insert the outside cylinder and housing into the 54mm (2 1/8") hole insuring the tail piece is horizontal for a right hand door and vertical for left hand door. Refer Handing chart over.

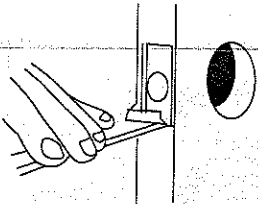

B. Chisel 3mm (1/8") deep or until bolt face plate is flush with door edge.

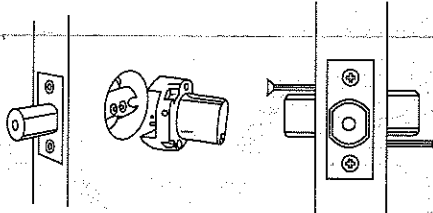

B. Insert the inside cylinder and housing into 54mm (2 1/8") hole insuring the tailpiece from the outside engages with back of cylinder. Install fixing screws one from either side. Check that the lock functions.

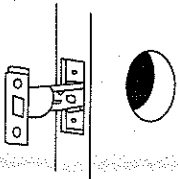

C. Install Tubular bolt in up position. Into hole in door edge. Drill and install fixing screws.

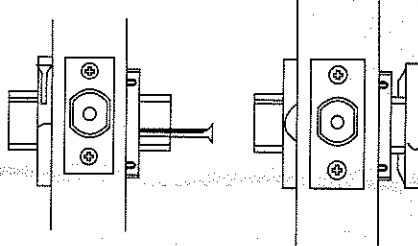

C. Install the outside escutcheon so that it sits flush to the door face. Install the inside fixing plate and fixing screws. Push on the inside escutcheon. Check that the lock functions.

Deadbolt Installation Instructions

5 Install Strike Plate

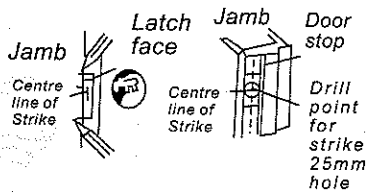

- A. Close door mark centre line of the bolt on jamb. Open door and extend mark to the door stop. Measure back from door stop half the door thickness and mark

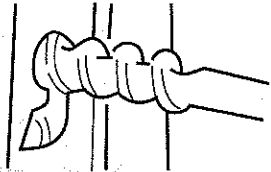

- B. Drill 25mm (1") hole, 25mm (1") deep at centre mark on Jamb.

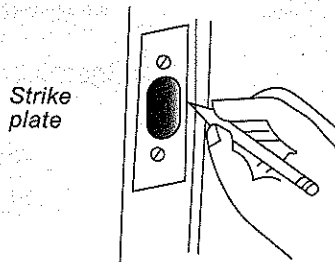

- C. Align strike plate and mark out line chisel 3mm (1/8") deep or until strike plate is flush with jamb. Chisel out behind the strike plate to accommodate nylon strike box.

