

# Passage Set Installation Instructions

## 1: Mark Door

- Fold and apply installation template to edge of door and mark centre of door edge as indicated on the template at the desired latch height.
- Mark centre hole on the door face through guide on template for 60mm (2 3/8") backset.
- Mark the two through fix holes on the door face

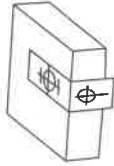

## 2: Drill holes

- Drill 25mm (1") hole in edge of door to the depth of the entire Latch.
- Drill through door face as marked one 25mm (1") to 35mm (1 5/8") hole through the door at 60mm (2 3/8") backset. It is recommended that a pilot hole be drilled through the door first.
- Drill through door face as marked two horizontal fixings 6.5mm (1/4") holes through the door.

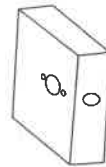

## 3: Install Latch

- Insert latch in hole, ensure the face plate is parallel to door edge. Mark outline of the face plate and remove latch.



- With a Chisel, mortise the latch faceplate into the edge of the door until it is flush with door edge.



- Install Latch into position in door edge. Drill and install fixing screws.



## 4: Install Lever Set

- Remove the outer rosettes from the levers. Insert the spindle through latch. Position the levers to both sides of the door.

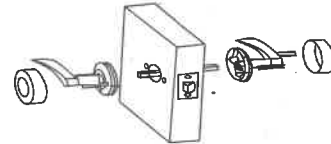

- Insert the fixing posts through the rosette on either side of the door. Insert the fixing screws from the opposing side and screw up tight.

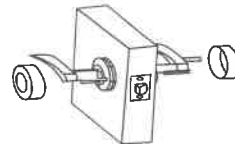

- Ensure the levers from both sides are turning and retract the latch. Replace outer rosettes

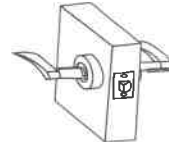

## Installation Template for Lemaar Tubular Latch.

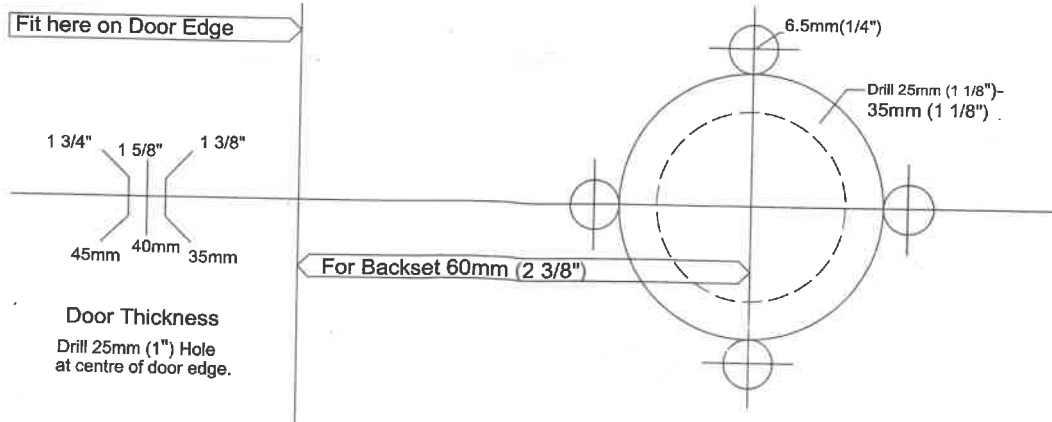

# Passage Set Installation Instructions

## 5: Install Strike Plate

A. Close door mark centre line of the bolt on jamb. Open door and extend mark to the door stop. Measure back from door stop half the door thickness and mark.

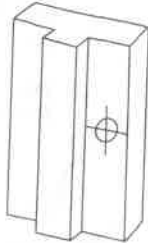

B. Drill 25mm (1") hole, 12 to 15mm (5/8") deep at centre mark on Jamb.

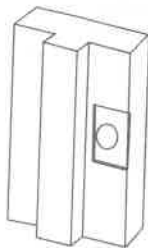

C. Align strike plate and mark out line chisel 3mm (1/8") deep or until strikeplate is flush with jamb.

